

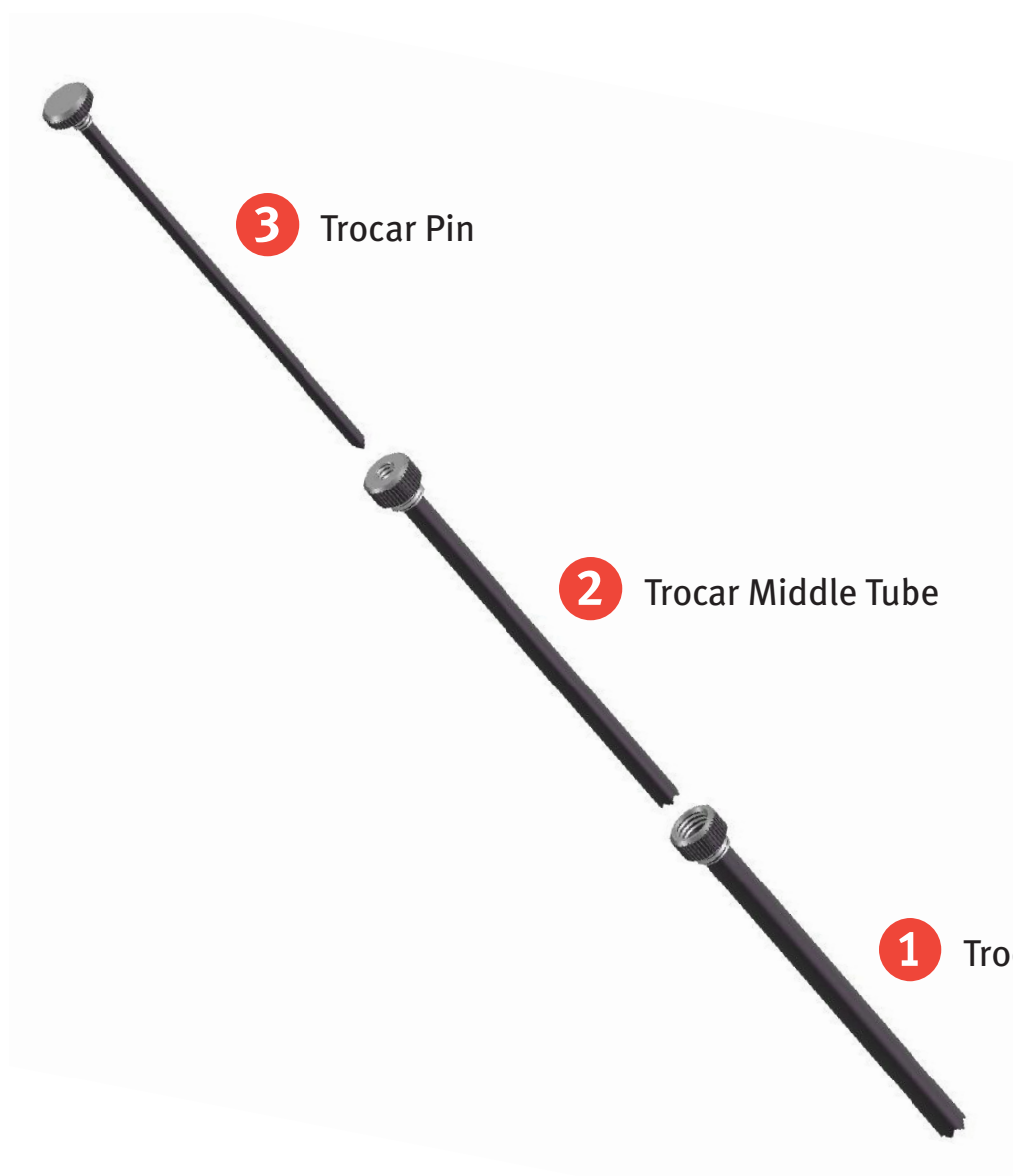

Drill Sleeve with Trocar (80mm)

00-4450-044-00

Assembly/Disassembly
Instructions



Disassembly Instructions for Drill Sleeve with Trocar

1. Unthread the Trocar Pin **3** and pull out of Trocar Middle Tube **2**.
2. Unthread the Middle Tube **2** and pull out of Trocar Outer Tube **1**.
3. End of disassembly.

Assembly Instructions for Drill Sleeve with Trocar

1. Insert the Trocar Middle Tube **2** inside the Trocar Outer Tube **1** and tighten completely.
2. Insert the Trocar Pin **3** inside the Trocar Middle Tube **2** and tighten completely.
2. End of assembly.



+H124970000520001/\$100610F10K

97-0000-520-00 1003-T38 Printed in USA ©2010 Zimmer, Inc.